

CARBONMAX CM-1 OPTIONED EQUIPMENT CONFIGURATION

CM-1 OPTIONED EQUIPMENT CONFIG.

ITEM #	NAME	DESCRIPTION	OPT.	COST
1	BARREL			
	A	CRITERION CORE 16" MID LENGTH GAS SYSTEM CHROME LINED 223 WYLDE CHAMBER 1-8 TWIST - 1/2-28 TPI MUZZLE THREADS, 5/8 GAS BLOCK JOURNAL (DIMPLED)*		\$00
	B-PRS-LTW	PROOF RESEARCH 16IN MID LENGTH CARBON OVER STAINLESS STEEL 223 WYLDE CHAMBER 1-8 OR 1-7 TWIST 5/8-24 TPI MUZZLE THREADS, 3/4 GAS BLOCK JOURNAL (DIMPLED)*		\$1200
	C-LTW	FAXON INTEGRAL® SERIES 16" GUNNER BRAKE PROFILE MID-LENGTH 4150 CMV BLACK NITRIDE 5.56 NATO 1-8 TWIST, NO MUZZLE THREADS, 5/8 GAS BLOCK JOURNAL (DIMPLED)		\$00
	D	FN AMERICA 16" MID LENGTH CHE MIL-B-11595E CRMVO STEEL, MPI TESTED, 5.56 CHAMBER		\$250
	E-LTW	CARBON SIX AR 16" MID LENGTH GAS SYSTEM (CUSTOM CHAMBERING (223 WYLDE, 5.56 NATO)		\$1800
	F-TAX-LTW	CRITERION ULTRALIGHT 14.5IN MID LENGTH GAS SYSTEM, CHROME LINED 223 WYLDE CHAMBER 1-8 TWIST - 1/2-28 TPI MUZZLE THREADS, 3/4IN GAS BLOCK JOURNAL (DIMPLED)*		\$150
	G-TAX-LTW	FAXON DUTY SERIES 11.5" MID-LENGTH GAS SYSTEM 4150 CMV BLACK NITRIDE 5.56 NATO 1-8 TWIST, 1/2-28 TPI MUZZLE THREADS, 5/8 GAS BLOCK JOURNAL (DIMPLED)		\$00
	H-300	BCM STANDARD 12.5IN 300BLK 11595E CHROME LINED PHOSPHATE EXTERIOR 1-7TWIST - 5/8-24 TPI MUZZLE THREADS, 3/4IN GAS BLOCK		\$150
	I	USER PROVIDED:		\$75
2	MUZZLE DEVICE			
	A	VG6A EPSILON 556*		\$00
	B	UNRIVALED A2 SUPPRESSOR ADAPTER SIEGE BRAKE* SUPPRESSOR:		\$00
	C-TAX	(INCLUDES SETUP SHEET FOR GAS/MASS)		\$250
	D	USER PROVIDED:		
3	GAS SYSTEM			
	A	RIFLESPEED 12 POSITION ADJUSTABLE GAS BLOCK		\$00
	B-LTW	WRAITHWORKS ULTRALIGHTWEIGHT 3 POSITION ADJUSTABLE GAS BLOCK*		\$500
4	BOLT AND CARRIER			
	A	JP BOLT - UNRIVALED PERFORMANCE DUTY BOLT CARRIER*		\$00
	B	JP BOLT - UNRIVALED PERFORMANCE LIGHTWEIGHT BOLT CARRIER*		\$250
	C	JP-BOLT-JPVMOS ADJUSTABLE WEIGHT CARRIER* (REQUIRED FOR CUSTOM CHAMBERED, BARREL E-LTW)		\$350
5	TRIGGER			
	A	ELF APEX TRIGGER WITH CUSTOM SHOE*		\$00
	B	GEISSELE 55A-E TRIGGER		\$150
6	SAFETY			
	A	WRAITHWORKS AMBI SAFETY WITH ADDITIONAL PADDLES*		\$00
	B	USER PROVIDED:		\$00
7	BUFFER SYSTEM			
	A	JP CAPTURED BUFFER SYSTEM WITH 2 TUNGSTEN AND 2 STEEL (SEE SETUP CHART FOR DETAILS)		\$00
	B	UNRIVALED INDUSTRIES - DUTY BUFFER		\$50
	C	UNRIVALED INDUSTRIES - COMPETITION BUFFER		\$50
8	GRIP			
	A	MAGPUL K2+*		\$00
	B	USER PROVIDED:		\$00
9	MAG RELEASE			
	A	CMMG ZEROED AMBI MAG RELEASE*		\$00
	B	TROY INDUSTRIES INC. AMBI MAG RELEASE		\$25
	C	USER PROVIDED:		
10	OFF	OPTICS FIT AND FUNCTION TEST		\$250
11	OLFFT-LTW	OPTICS FIT AND FUNCTION TEST, LIGHT, LASER, WIRE TUCK (REQUIRES LTW RAIL) (REQUIRES CUSTOMER APPROVAL OF POSITION, FUNCTION AND FIT OF AND DEVICES PROVIDED WITHIN 30 DAYS OF DELIVERY DATE)		\$500
12	OLFFT-OPS-LTW	OPTICS FIT AND FUNCTION TEST, LIGHT, LASER, WIRE TUCK, OPS PACK BUTTON INTEGRATION (REQUIRES LTW RAIL) (REQUIRES CUSTOMER APPROVAL OF POSITION, FUNCTION AND FIT OF AND DEVICES PROVIDED WITHIN 30 DAYS OF DELIVERY DATE)		\$1500
13	OPS-SUITE	TBA		\$TBA

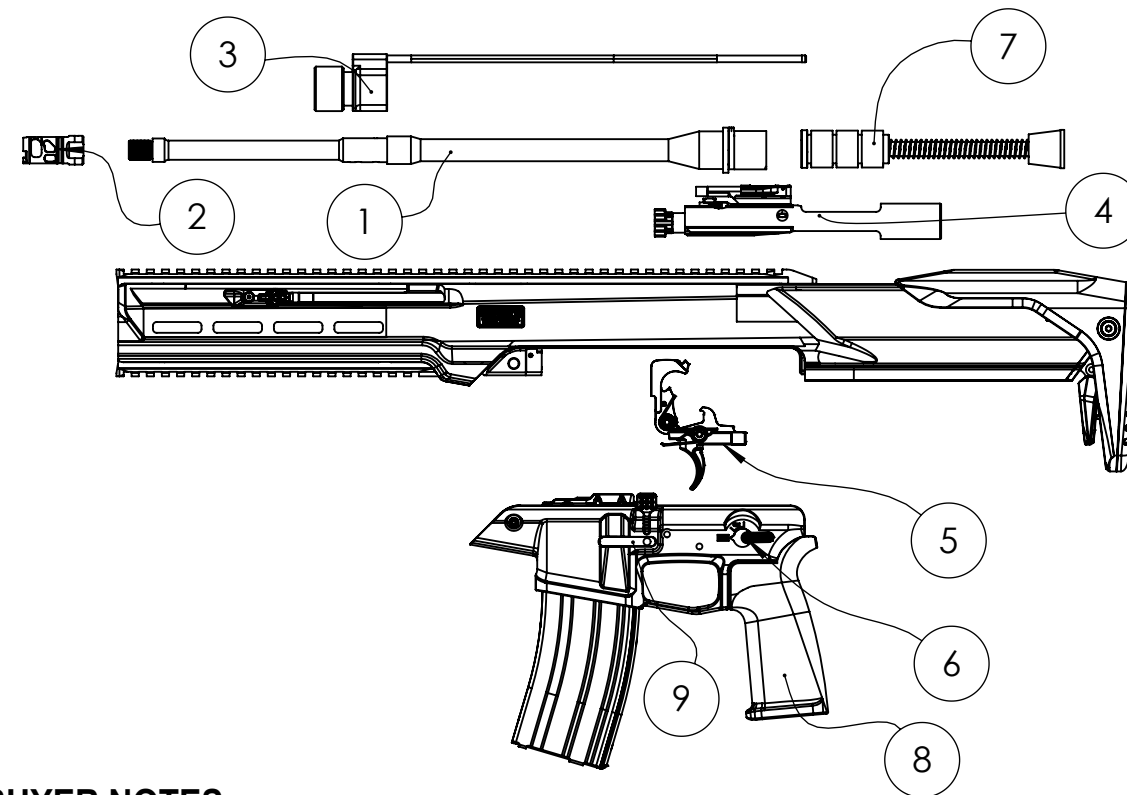

BUYER NOTES:

PREFERRED MUNITIONS:

- _____
- _____
- _____

PREFERRED SERIAL: _____

EXAMPLE: 0004-0054

BUYER APPROVAL: _____ DATE: ___/___/___

BUILDER APPROVAL: _____ DATE: ___/___/___

NOTES:

- SELECT DESIRED COMPONENTS, CONFIRM CONFIGURATION BY SUBMITTING VIA EMAIL TO JOSH.G@WRAITHWORKS.COM
- IF COMPONENTS ARE USER PROVIDED PLEASE NOTE TYPE
- *COMPONENTS SHOWN MAY NOT VISUALLY PORTRAY PARTS IN THE DESCRIPTION
- 1/2 DOWN - 1/2 WHEN SHIPPED OR DELIVERED (PICK AND CONFIRM DELIVERY DATE VIA WEB STORE PROCESS)

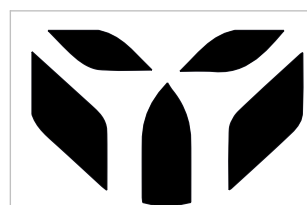

PROPRIETARY AND CONFIDENTIAL

THE INFORMATION CONTAINED IN THIS DRAWING IS THE SOLE PROPERTY OF ROUGHRIDER ARMS LLC. ANY REPRODUCTION IN PART OR AS A WHOLE WITHOUT THE WRITTEN PERMISSION OF ROUGHRIDER ARMS LLC IS PROHIBITED.

UNLESS OTHERWISE SPECIFIED:		NAME	DATE	<p>TITLE: CARBONMAX CM-1 OPTION EQUIP</p> <p>SIZE B DWG. NO. WW-CARBONMAX-CONFIG REV A</p> <p>SCALE: 1:10 WEIGHT: SHEET 2 OF 3</p>
DIMENSIONS ARE IN INCHES TOLERANCES:		DRAWN	JG 1/2/26	
FRACTIONAL ±1/32 IN.		CHECKED		
ANGULAR: MACH ±1 BEND ±1 TWO PLACE DECIMAL ±0.010		ENG APPR.		
THREE PLACE DECIMAL ±0.002		MFG APPR.		
FOUR PLACE DECIMAL ±0.0005		Q.A.		
INTERPRET GEOMETRIC TOLERANCING PER: 3D MODEL		COMMENTS:		
MATERIAL	VARIES			
FINISH	VARIES			
NEXT ASSY	USED ON			
APPLICATION		DO NOT SCALE DRAWING		

4

3

2

1

CARBONMAX CM-1 OPTIONED FINISH CONFIGURATION

CM-1 OPTIONED EQUIPMENT CONFIG.

ITEM #	NAME	DESCRIPTION	OPT.	COST
1	METTALIC FINISH			
		A	FLAT BLACK TYPE 2 HARDCOAT ANODIZED PIC RAIL AND LOWER, RAW TITANIUM CHARGING HANDLE AND EJECTOR PORT	\$00
		B	FLAT BLACK TYPE 2 HARDCOAT ANODIZED PIC RAIL AND LOWER, MATTE BLACK TITANIUM CHARGING HANDLE AND EJECTOR PORT	\$250
		C	MATTE SILVER TYPE 2 HARDCOAT ANODIZED PIC RAIL AND LOWER, RAW CHARGING HANDLE AND EJECTOR PORT	\$250
2	COMPOSITE FINISH			
		X	RAW FINISH FROM TOOL HIGH LUSTER	\$00
		Y	MATTE MATTE CLEAR CERAKOTE	\$175

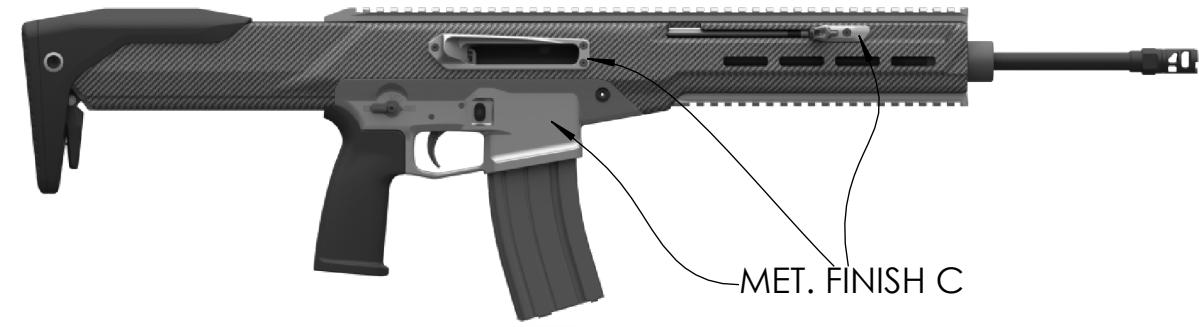
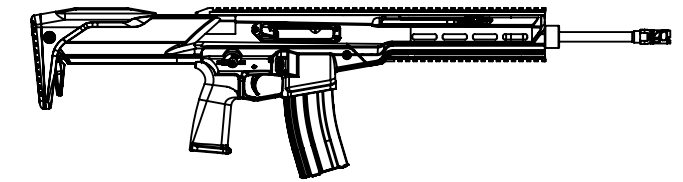
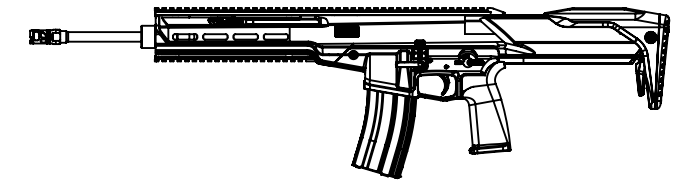

BUYER NOTES:

BUYER APPROVAL: _____ DATE: ___/___/___

BUILDER APPROVAL: _____ DATE: ___/___/___

NOTES:

1. SELECT DESIRED FINISHES, CONFIRM CONFIGURATION BY SUBMITTING VIA EMAIL TO JOSH.G@WRAITHWORKS.COM
2. IF COMPONENTS ARE USER PROVIDED PLEASE NOTE TYPE
3. *COMPONENTS SHOWN MAY NOT VISUALLY PORTRAY PARTS IN THE DESCRIPTION
4. 1/2 DOWN - 1/2 WHEN SHIPPED OR DELIVERED (PICK AND CONFIRM DELIVERY DATE VIA WEB STORE PROCESS)

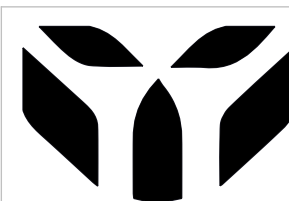

PROPRIETARY AND CONFIDENTIAL

THE INFORMATION CONTAINED IN THIS DRAWING IS THE SOLE PROPERTY OF ROUGHRIDER ARMS LLC. ANY REPRODUCTION IN PART OR AS A WHOLE WITHOUT THE WRITTEN PERMISSION OF ROUGHRIDER ARMS LLC IS PROHIBITED.

		UNLESS OTHERWISE SPECIFIED: DIMENSIONS ARE IN INCHES TOLERANCES: FRACTIONAL ±1/32 IN. ANGULAR: MACH ±1 BEND ±1 TWO PLACE DECIMAL ±0.010 THREE PLACE DECIMAL ±0.002 FOUR PLACE DECIMAL ±0.0005	NAME	DATE
			JG	1/2/26
		INTERPRET GEOMETRIC TOLERANCING PER: 3D MODEL		
		MATERIAL		
		FINISH		
NEXT ASSY	USED ON			
APPLICATION		DO NOT SCALE DRAWING		

DRAWN	NAME	DATE
CHECKED		
ENG APPR.		
MFG APPR.		
Q.A.		
COMMENTS:		

WRAITHWORKS

TITLE: **CARBONMAX CM-1 OPTION FINISH**

SIZE	DWG. NO.	REV
B	WW-CARBONMAX-CONFIG	A

SCALE: 1:10 WEIGHT: SHEET 3 OF 3

4

3

2

1

B

B

A

A